

Bolt Tensioner

Series : BT

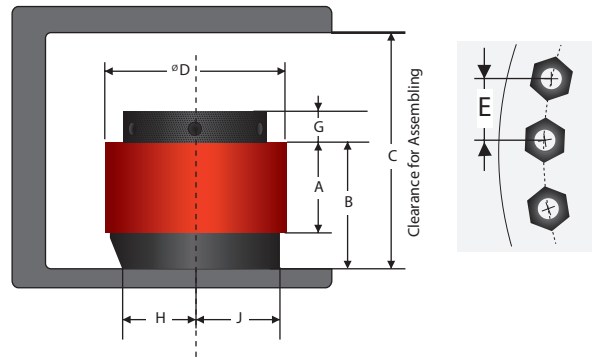

Max. working pressure : 1500 bar



- Compact design, makes easy to fit in confined spaces.
- Models are available in metric and imperial sizes.
- Suitable for tightening multiple bolts at a time.
- Wear plated piston.
- Maximum piston stroke indicator.
- Suitable to operate with manual or air driven hydraulic pumps.
- Fitted with high pressure M/F couplers.

Model		Bolt/Stud Sizes		Capacity		Stroke	Effective Area	Dimensions (mm)								Weight
Metric	Imperial	Metric	Inch	Ton	KN	mm	cm ²	A	B	C	D	E	G	H	J	Kg
BT 1-24-16		M16		24	235.5	10	15.7	62	90	168	75	49	16	30	32.5	2
BT 1-24-18	BT 1-24-075	M18	3/4"													
BT 1-24-20		M20														
BT 1-24-22	BT 1-24-087	M22	7/8"													
BT 1-24-24	BT 1-24-100	M24	1"	50.5	495		33	106	187	102	60	22	36	47	4	
BT 2-50-27	BT 2-50-112	M27	1.1/8"													
BT 2-50-30		M30														
BT 2-50-33	BT 2-50-125	M33	1.1/4"													
BT 2-50-36	BT 2-50-137	M36	1.3/8"	91	895.5		59.7	120	208	133	76	28	49	61	6	
BT 3-90-39	BT 3-90-150	M39	1.1/2"													
BT 3-90-42	BT 3-90-162	M42	1.5/8"													
BT 3-90-45	BT 3-90-175	M45	1.3/4"													
BT 3-90-48	BT 3-90-187	M48	1.7/8"	127	1245	15	83	135	231	163	104	34	59	73	10	
BT 3-90-52	BT 3-90-200	M52	2"													
BT 4-125-48	BT 4-125-187	M48	1.7/8"													
BT 4-125-52	BT 4-125-200	M52	2"													
BT 4-125-56	BT 4-125-225	M56	2.1/4"	188	1845		123	150	254	193	110	42	66	86.5	15	
BT 4-125-60		M60														
BT 4-125-64	BT 4-125-250	M64	2.1/2"													
BT 5-185-64	BT 5-185-250	M64	2.1/2"													
BT 5-185-68		M68		269	2640		176	73	180	286	233	126	48	77	110	24.5
BT 5-185-72	BT 5-185-275	M72	2.3/4"													
BT 5-185-76	BT 5-185-300	M76	3"													
BT 6-265-76	BT 6-265-300	M76	3"													
BT 6-265-80		M80										136				
BT 6-265-85	BT 6-265-325	M85	3.1/4"													
BT 6-265-90	BT 6-265-350	M90	3.1/2"													
BT 6-265-95	BT 6-265-375	M95	3.3/4"													
BT 6-265-100	BT 6-265-400	M100	4"									144				